



COOK

CVR/CVR-S

DATE: _____

PROJECT: _____

LOCATION: _____



**Centri-Vane All Aluminum
Centrifugal Blower
Exhaust or Supply
Roof Mounted/Belt Drive**

DIMENSION DATA

Size	A	B	C	D	E	F	G	T	Shaft Dia.	Wheel Dia.	Ga. of Mat'l housing/base	Ship Wt. less Mtr.
10	20-1/8	4-5/8	15-1/2	16-3/16	15	18-1/8	2	20	3/4	12-15/16	.080/.080	92
12	22-1/8	5	17-1/8	19-1/8	15	27-15/16	2	20	1	15-9/16	.100/.080	98
14	24-1/8	5	19-1/8	22	16	27-15/16	2	24	1	18-1/4	.100/.080	121
16	26-9/16	5	21-9/16	24-7/8	17	27-15/16	2	24	1	20-15/16	.100/.080	143
18	29-1/2	5	24-1/2	27-3/4	19	27-15/16	2	28	1	23-9/16	.100/.080	208
20	33-1/4	6-3/4	26-1/2	30-1/2	19	36	2	28	1	26-1/4	.100/.080	274
24	38-1/8	6-3/4	31-3/8	36-1/2	21	36	3	32	1-3/16	31-9/16	.100/.080	369
28	44	8	36	42	29	42-1/8	3	36	1-11/16	36-7/8	.100/.080	491
32	57-7/8	17	40-7/8	48	30	52	3	42	1-11/16	42-3/16	.125/.080	625
36	61-1/2	17-1/2	44	53-3/8	32	62	3	48	1-15/16	47-1/2	.125/.080	767

ALL DIMENSIONS IN INCHES. WEIGHTS IN LBS. DRIVES THROUGH 5 H.P. ARE ALL VARIABLE PITCH.

STANDARD CONSTRUCTION FEATURES:

All aluminum construction - Spun aluminum top cap with built in air deflector - Weather cover - Straightening vanes - Regreasable bearings in a cast housing rated at 200,000 hours average life - Extended lube lines - Bearings and belts out of the airstream - Static resistant belts - Supply fan can be used for stair well pressurization - All fans factory adjusted to specified fan RPM - Five year fan warranty.

ACCESSORIES

1. DISCONNECT SWITCH
2. RCG GALVANIZED CURB
3. RCA ALUMINUM CURB
4. EPOXY COATING

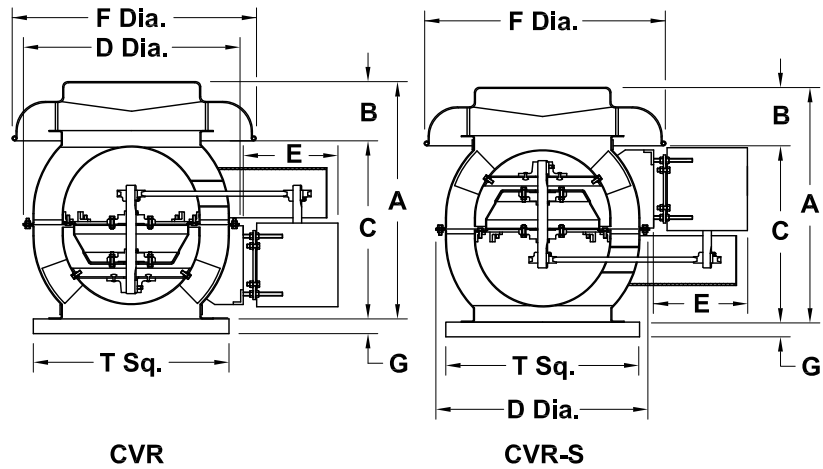

QTY	MARK	CATALOG NUMBER	FAN INFORMATION			MOTOR INFORMATION					ACCESSORIES							
			CFM	SP	RPM	HP	VOLTS	HZ	PH	TYPE								

LARGEST MOTOR SHIPPED MOUNTED: ODP (OPEN DRIP-PROOF) 2 HP; 2 SP (2 SPEED) 1 HP; X-PRF (EXPLOSION PROOF) 1 HP; TEFC (TOTALLY ENCLOSED FAN COOLED) 1 HP.