



# COOK

# AUD

DATE: \_\_\_\_\_  
 PROJECT: \_\_\_\_\_  
 LOCATION: \_\_\_\_\_



**Propeller Upblast  
 Exhaust Ventilator  
 Aluminum or Steel  
 Roof Mounted/Direct Drive**

**DIMENSION DATA**

Size	A Dia.	B	C	D	E	F	T Sq.	Max. Motor Frame	Ship Wt. Steel	Ship Wt. Alum.	Roof Opening Sq.*
24	31	19-1/8	47-3/4	4	3	14	36	145T	221	185	31-1/2
30	37	23-5/8	52-3/8	3-7/8	3	15	42	184T	317	271	37-1/2
36	43	25-5/8	60-7/8	4	3	17	48	256T	489	379	43-1/2
42	49	27-7/8	63-5/8	4	3	17	54	256T	636	484	49-1/2
48	55	31-1/4	67	4	3	17	60	256T	773	591	55-1/2

ALL DIMENSIONS IN INCHES. WEIGHTS IN LBS.  
 \* ROOF OPENING SIZE FOR CURBS SUPPLIED BY COOK ONLY.

**STANDARD CONSTRUCTION FEATURES:**

Cast Aluminum propeller – Spun steel Venturi/curb cap – Heavy gauge, painted steel lower drum – 2 point lifting lugs – Painted steel windband – Structural steel power assembly – Butterfly damper doors (24-36 alum, 42-48 galv. steel) – Welded curb cap corners – Corrosion resistant fasteners.

**ACCESSORIES**

1. NEMA 3 DISCONNECT SWITCH
2. INLET BASKET GUARD
3. DISCHARGE GUARD
4. MAGNETIC LATCHES
5. ACCESS DOOR
6. HINGED SUB-BASE
7. RCG GALVANIZED CURB
8. RCA ALUMINUM CURB
9. EPOXY COATING
10. ANTI-CONDENSATE COATING
11. PHENOLIC EPOXY COATING
12. PRIME COAT

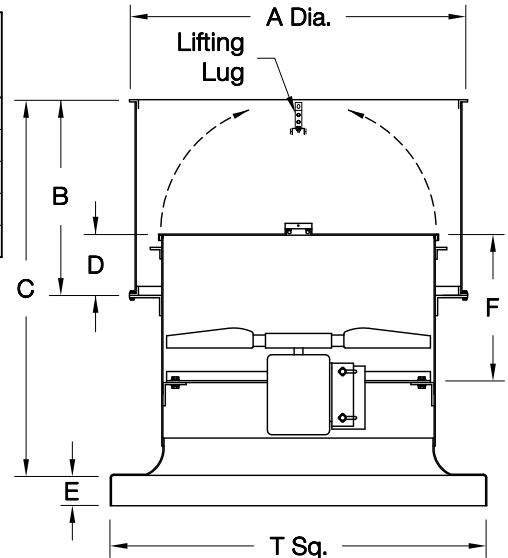

QTY	MARK	CATALOG NUMBER	FAN INFORMATION			MOTOR INFORMATION					ACCESSORIES									
			CFM	SP	RPM	HP	VOLTS	HZ	PH	TYPE										

**MOTOR TYPE:** ODP (OPEN DRIP-PROOF); 2 SP (2 SPEED); X-PRF (EXPLOSION PROOF); TEFC (TOTALLY ENCLOSED FAN COOLED).

RP002R04