

DATE: \_\_\_\_\_  
 PROJECT: \_\_\_\_\_  
 LOCATION: \_\_\_\_\_



**Mixed Flow Inline  
 Horizontal Mount  
 Low/High Pressure Wheel  
 Direct Drive  
 Arrangement 4  
 Percent Widths 64-100 (QMXD-HP Only)**

**STANDARD CONSTRUCTION FEATURES:**

High efficiency mixed flow wheel - Continuously welded steel housing with Lorenized powder coating - Welded aerodynamic straightening vanes - Integral inlet and outlet collars for slip fit duct connections - extended lube lines with motor zerk-lifting lugs - Adjustable mounting feet- Leads run to NEMA 1 Wiring Compartment

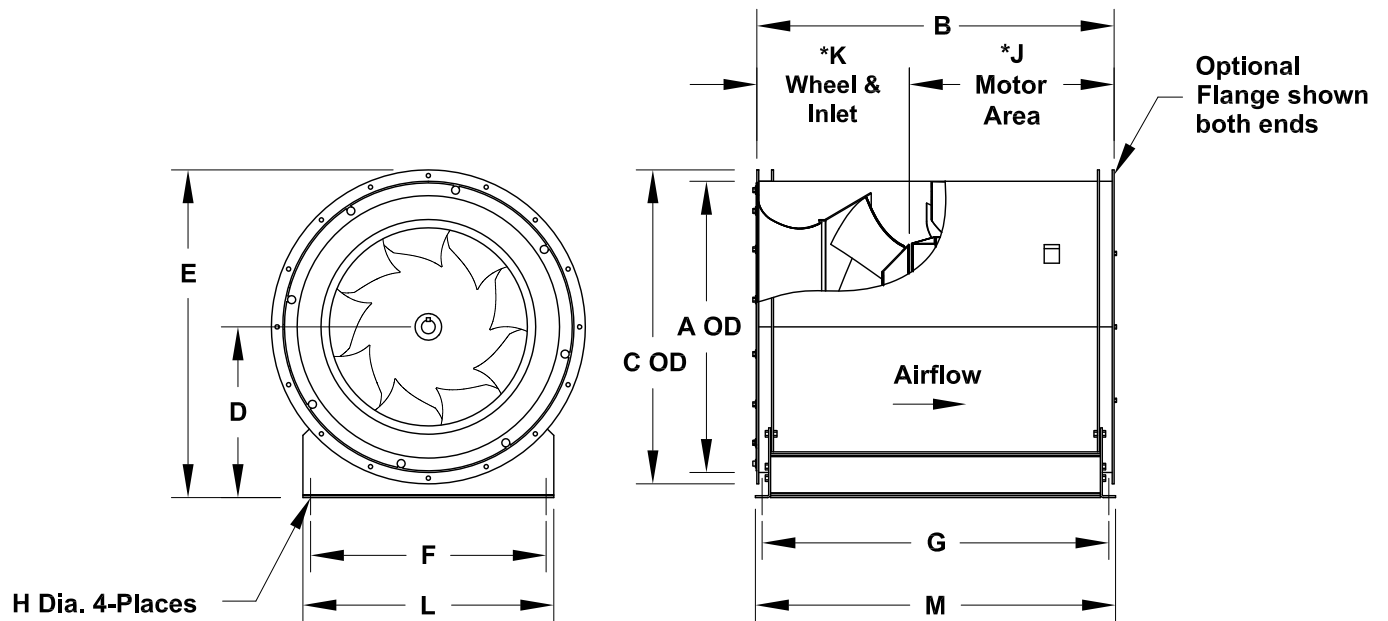

\*Dimensions J & K will change on QMXD-HP percent width wheels.

**DIMENSION DATA**

Size	A	B	C	D	E	F	G	H	J*	K*	L	M
150	21-3/8	30	24-3/8	13-3/16	25-3/8	18-3/4	28-5/8	1/2	17-5/8	12-3/8	20-3/4	30-1/4
165	23-1/2	33	26-1/2	14-5/16	27-9/16	20-13/16	31-5/8	1/2	19-3/8	13-5/8	22-13/16	33-1/4
180	25-5/8	35	28-5/8	15-1/2	29-13/16	22-13/16	33-5/8	9/16	20-1/4	14-3/4	24-13/16	35-1/8
202	28-3/4	37-1/2	31-3/4	17-1/4	33-1/8	24-1/4	36-1/8	9/16	20-13/16	16-11/16	26-1/4	37-3/4
225	31-15/16	41	34-15/16	19	36-1/2	26-15/16	39-5/8	9/16	22-7/16	18-9/16	28-15/16	41-1/4
245	34-3/4	44-1/2	37-3/4	20-1/2	39-3/8	28-15/16	43-1/8	11/16	24-3/8	20-1/8	30-15/16	44-3/4
270	38-5/16	47	41-5/16	22-7/16	43-1/8	31	45-5/8	11/16	24-3/4	22-1/4	33	47-1/4
300	42-1/2	54	45-1/2	24-3/4	47-1/2	33-3/4	52-5/8	11/16	32-5/16	21-11/16	35-3/4	54-1/4
330	46-3/4	58-1/2	49-3/4	27	51-7/8	36-3/4	57-1/8	11/16	34-13/16	23-11/16	38-3/4	58-3/4
365	51-3/4	64	54-3/4	29-13/16	57-3/16	40-1/2	63-3/8	13/16	37-11/16	26-5/16	42-1/2	65-1/4
402	56-15/16	68-1/2	59-15/16	32-11/16	62-11/16	44	67-7/8	13/16	39-1/2	29	46	69-3/4
445	63-1/16	74	66-1/16	36	69-1/16	48-1/4	73-3/8	13/16	42	32	50-1/4	75-1/4
490	69-3/8	80-1/2	72-3/8	39-7/16	75-5/8	52-3/4	79-7/8	13/16	45-1/4	35-1/4	54-3/4	81-3/4
540	76-7/16	87	79-7/16	43-5/16	83-1/16	58	86-3/8	13/16	48-3/16	38-13/16	60	88-1/4
600	84-7/8	95-1/2	87-7/8	50	93-15/16	64	94-7/8	13/16	52-3/8	43-1/8	66	96-3/4

ALL DIMENSIONS IN INCHES. WEIGHTS IN LBS., LESS MOTOR.