



COOK

RCG/RCA PEAKED

DATE: _____
 PROJECT: _____
 LOCATION: _____

**Galvanized Steel or Aluminum
 Roof Curb**

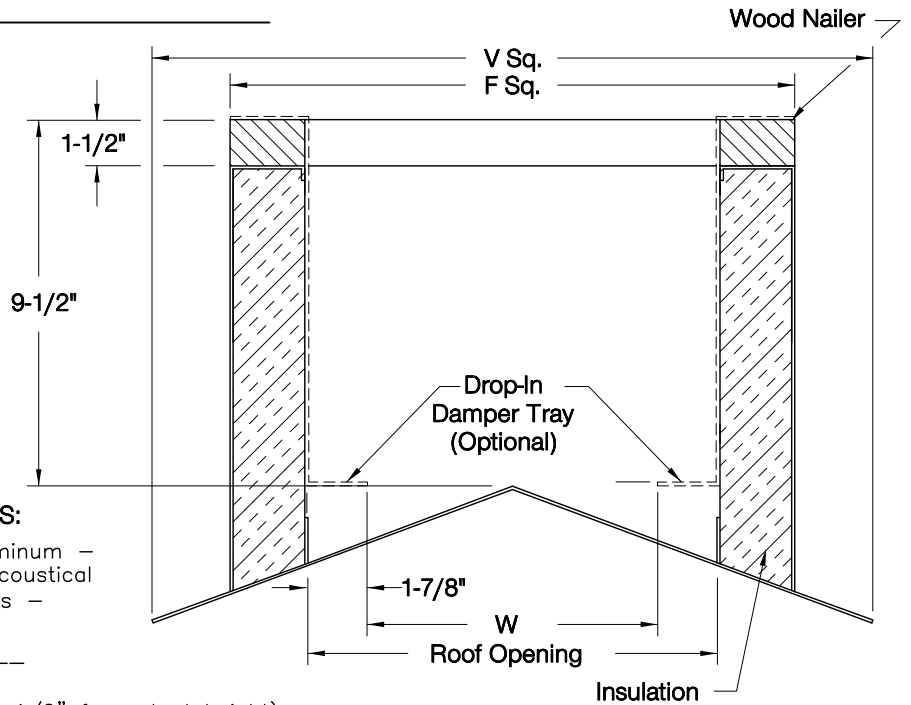

STANDARD CONSTRUCTION FEATURES:

18 gauge galvanized steel or .080 aluminum – 1-1/2", 3 lbs. density thermal and accoustical insulation – Continuously welded corners – Wood nailer.

Required pitch: rise _____ run _____

- Options: 1) Drop-in damper tray
 2) No wood nailer (deduct 1-1/2" for actual height)
 3) 13-1/2" high

Note: Lo-Pro, CFS and UCIC units require heavy duty curbs.
 This is designated by adding the letter H to the Catalog Number.
 For example, a heavy duty RCG would be RCGH.

DIMENSION DATA

Qty	Mark	Centrifugal Units	Lo-Pro* Units	PR/TR Propeller Units	Economizer Units	UCV CVR Units	UCIC* Units	ASP/KSP Units	Cat. No.		F Sq.	V Sq.	W Sq.	Roof Open.	Ship Wt.	
									Galv.	Alum.					Galv.	Alum.
		60,70 80,90,100	–	8	–	–	–	–	RCG-16	RCA-16	16-1/2	20-1/2	9-3/4	13-1/2	24	16
		120,135	100	12	–	12	–	–	RCG-18	RCA-18	18-1/2	22-1/2	11-3/4	15-1/2	27	18
		150,165	120,135 150,165	–	–	14,16	120	90	RCG-22	RCA-22	22-1/2	26-1/2	15-3/4	19-1/2	32	21
		–	–	16	–	18,20	135	100	RCG-26	RCA-26	26-1/2	30-1/2	19-3/4	23-1/2	38	25
		180,195 210,225,245	180,195 210,225	–	–	–	150,165	–	RCG-28	RCA-28	28-1/2	32-1/2	21-3/4	25-1/2	41	27
		–	–	20	–	24	–	120,150	RCG-30	RCA-30	30-1/2	34-1/2	23-3/4	27-1/2	44	28
		270,300	245,270	24	–	28	180	180	RCG-34	RCA-34	34-1/2	38-1/2	27-3/4	31-1/2	50	32
		–	–	–	24	–	–	–	RCG-35	RCA-35	35-1/2	39-1/2	28-3/4	32-1/2	52	32
		330,365	300,330	30	–	32	210,225	–	RCG-40	RCA-40	40-1/2	44-1/2	33-3/4	37-1/2	58	37
		–	–	–	30	–	–	–	RCG-41	RCA-41	41-1/2	45-1/2	34-3/4	38-1/2	60	38
		402	365,402	36	–	36	245	200	RCG-46	RCA-46	46-1/2	50-1/2	39-3/4	43-1/2	100	76
		–	–	–	36	–	–	–	RCG-47	RCA-47	47-1/2	51-1/2	40-3/4	44-1/2	102	–
		445,490	–	42	–	–	–	–	RCG-52	RCA-52	52-1/2	56-1/2	45-3/4	49-1/2	113	–
		–	–	–	42	–	–	–	RCG-53	RCA-53	53-1/2	57-1/2	46-3/4	50-1/2	115	–
		–	–	48	–	–	–	–	RCG-58	RCA-58	58-1/2	62-1/2	51-3/4	55-1/2	125	–
		–	–	–	48	–	–	–	RCG-59	RCA-59	59-1/2	63-1/2	52-3/4	56-1/2	127	–
		540	–	54	–	–	–	–	RCG-64	RCA-64	64-1/2	68-1/2	57-3/4	61-1/2	138	–
		–	–	–	54	–	–	–	RCG-65	RCA-65	65-1/2	69-1/2	58-3/4	62-1/2	139	–
		–	–	60	–	–	–	–	RCG-70	RCA-70	70-1/2	74-1/2	63-3/4	67-1/2	150	–
		–	–	72	–	–	–	–	RCG-82	RCA-82	82-1/2	86-1/2	75-3/4	79-1/2	175	–

* SEE SUBMITTAL RCGH FOR ADDITIONAL SIZES.
 ALL DIMENSIONS IN INCHES. WEIGHTS IN LBS.