



COOK

MOTOR SLIDE BASE

DATE: _____

Stock T-Frame for Belt Drive

PROJECT: _____

LOCATION: _____

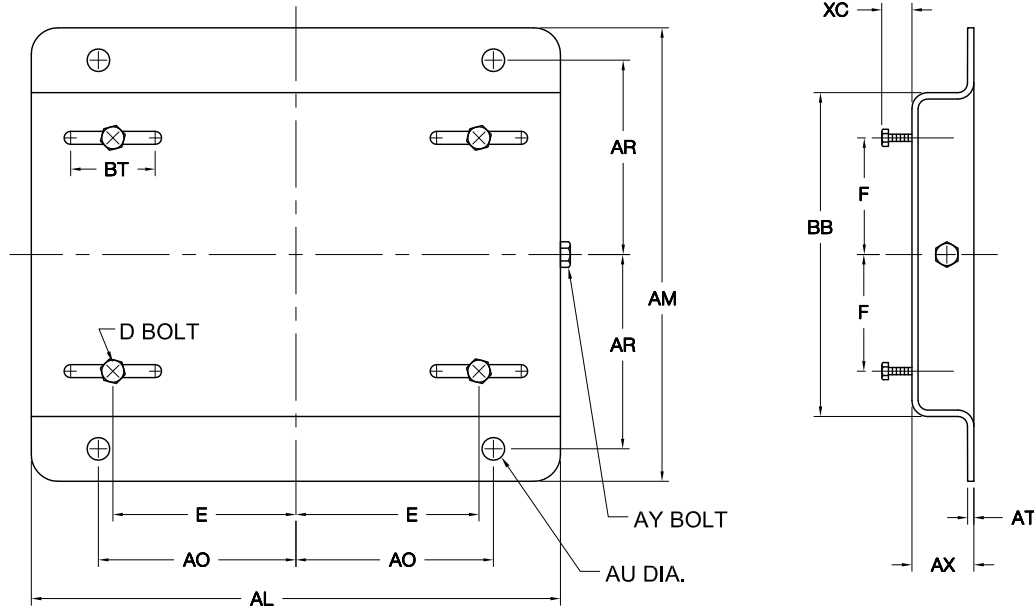

Note: Steel construction, with oven baked finish.

Frame	AL	AM	AX	BB	E	F	AO	AR	AU	BT	AT	XC	D Bolt	AY Bolt	Approx. Weight
48	10	6-1/4	1-1/8	4-1/4	2-1/8	1-3/8	3-1/2	2-3/4	3/8	3	.078	7/8	5/16 X 1	3/8 X 4	2
56	10-5/8	6-1/2	1-1/8	4-1/2	2-7/16	1-1/2	3-13/16	2-7/8	3/8	3	.078	7/8	5/16 X 1	3/8 X 4	3
143	10-1/2	7-1/2	1-1/8	5-1/2	2-3/4	2	3-3/4	3-3/8	3/8	3	.119	13/16	5/16 X 1	3/8 X 4	5
145	10-1/2	8-1/2	1-1/8	6-1/2	2-3/4	2-1/2	3-3/4	3-7/8	3/8	3	.119	13/16	5/16 X 1	3/8 X 4	6
182	12-3/4	9-1/2	1-1/2	6-1/2	3-3/4	2-1/4	4-1/2	4-1/4	1/2	3	.134	1-1/2	3/8 X 1-3/4	1/2 X 6	9
184	12-3/4	10-1/2	1-1/2	7-1/2	3-3/4	2-3/4	4-1/2	4-3/4	1/2	3	.134	1-1/2	3/8 X 1-3/4	1/2 X 6	9
213	15	11	1-3/4	7-1/2	4-1/4	2-3/4	5-1/4	4-3/4	1/2	3-1/2	.164	1-1/2	3/8 X 1-3/4	1/2 X 6	13
215	15	12-1/2	1-3/4	9	4-1/4	3-1/2	5-1/4	5-1/2	1/2	3-1/2	.164	1-1/2	3/8 X 1-3/4	1/2 X 6	15
254	17-3/4	15-1/8	2	10-3/4	5	4-1/8	6-1/4	6-5/8	5/8	4	3/16	1-7/16	1/2 X 1-3/4	1/2 X 6	17
256	17-3/4	16-7/8	2	12-1/2	5	5	6-1/4	7-1/2	5/8	4	3/16	1-7/16	1/2 X 1-3/4	5/8 X 6	18
284	19-3/4	16-7/8	2	12-1/2	5-1/2	4-3/4	7	7-1/2	5/8	4-1/2	3/16	1-11/16	1/2 X 2	5/8 X 6	21
286	19-3/4	18-3/8	2	14	5-1/2	5-1/2	7	8-1/4	5/8	4-1/2	3/16	1-11/16	1/2 X 2	5/8 X 6	22
324	22-3/4	19-1/4	2-1/2	14	6-1/4	5-1/4	8	8-1/2	3/4	5-1/4	3/16	2-3/16	5/8 X 2-1/2	3/4 X 9	31
326	22-3/4	20-3/4	2-1/2	15-1/2	6-1/4	6	8	9-1/4	3/4	5-1/4	3/16	2-3/16	5/8 X 2-1/2	3/4 X 9	32
364	25-1/2	20-1/2	2-1/2	15-1/2	7	5-5/8	9	9-1/8	3/4	6	1/4	2-1/16	5/8 X 2-1/2	3/4 X 9	44
365	25-1/2	21-1/2	2-1/2	16-1/2	7	6-1/8	9	9-5/8	3/4	6	1/4	2-1/16	5/8 X 2-1/2	3/4 X 9	45
404	28-3/4	22-3/8	3	16-1/2	8	6-1/8	10	9-7/8	7/8	7	1/4	2-1/2	3/4 X 3	3/4 X 11	60
405	28-3/4	23-7/8	3	18	8	6-7/8	10	10-5/8	7/8	7	1/4	2-1/2	3/4 X 3	3/4 X 11	61
444	31-1/4	24-5/8	3	19-1/4	9	7-1/4	11	11	7/8	7-1/2	1/4	2-1/2	3/4 X 3	3/4 X 11	67
445	31-1/4	26-5/8	3	21-1/4	9	8-1/4	11	12	7/8	7-1/2	1/4	2-1/2	3/4 X 3	3/4 X 11	69
447	31-1/4	30-1/8	3	24-3/4	9	10	11	13-3/4	7/8	7-1/2	5/16	3	3/4 X 3-1/2	3/4 X 11	92
449	31-1/4	35-1/8	3	29-3/4	9	12-1/2	11	16-1/4	7/8	7-1/2	5/16	3	3/4 X 3-1/2	3/4 X 11	95
505	35	30	3-1/2	22-3/4	10	9	12-1/2	13-1/2	1	8	5/16	3	3/4 X 3-1/2	7/8 X 12	124

ALL DIMENSIONS IN INCHES